

PRODUCT: **RHOMBUS 36W LED RECESSED PANEL**  
PRODUCT CODES: **RB6636-40**

## BOX CONTENTS -

### 1 x Rhombus 36W LED Recessed Panel

1 x LED Driver

## SPECIFICATION

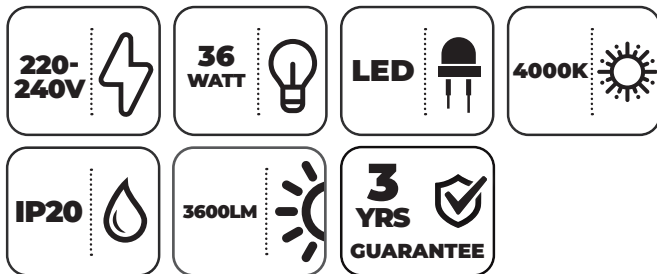

<b>Dimensions:</b>	L: 595 x W: 595 x D: 32mm
<b>Material:</b>	Body: Extruded Aluminium Frame & Steel Back Panel Diffuser: PS
<b>Working Temperature:</b>	-10~40°C

## MAINTENANCE

- This fitting will require routine cleaning if used in adverse (dust, paint, welding, oils etc) environments. Do not use solvents, aggressive detergents or abrasives.
- When this fitting comes to the end of its life or you choose to replace it, please do not dispose of it with your normal household waste. Please recycle where the facilities exist, check with your local authority or retailer for suitable options.



## MAXIMUM FITTINGS PER CIRCUIT

Automatic Circuit Breaker Type	B6	B10	B13	B16	B20	C10	C13	C16	C20
<b>Rated Current</b>	6A	10A	13A	16A	20A	10A	13A	16A	20A
<b>Cable (mm)</b>	1.5	1.5	1.5	1.5	2.5	1.5	1.5	1.5	2.5
<b>RB6636-40</b>	9	16	21	25	32	16	21	25	32

## SAFETY WARNING



- The installation should be carried out by a qualified electrician in compliance with the current edition of the IEE Wiring Regulations.
- Prior to installation, carry out the necessary risk assessment considering the people who could be at risk, the level of risk and the precautions required to control the risk
- Ensure that the circuit supply is isolated either by the circuit supply fuse being removed or the applicable circuit breaker being turned off before installation or any maintenance.
- Check the total load on the circuit ensuring the luminaire does not exceed the rating of the circuit cable, fuse or circuit breaker.
- Long-term use and voltage fluctuations can reduce the life span of the fitting.
- If the fitting incorporates control gear, ensure careful sizing to avoid instances of nuisance tripping of the protective device used in the installation.
- Follow the provided installation instructions, using the fixings supplied or recommended.
- Keep out of reach of children.

PRODUCT: **RHOMBUS 36W LED RECESSED PANEL**  
PRODUCT CODES: **RB6636-40**

## INSTALLATION INSTRUCTIONS - RECESSED

1. ENSURE THE POWER IS DISCONNECTED AND THEN REMOVE THE CEILING TILE OR EXISTING LIGHT FITTING FROM THE CEILING.
2. CONNECT THE WIRES FROM THE MAINS SUPPLY TO THE LED DRIVER.
3. FIT THE LED PANEL LIGHT INTO THE CEILING GRID. RECONNECT THE MAINS SUPPLY ONCE THE LED PANEL IS SECURELY IN POSITION.

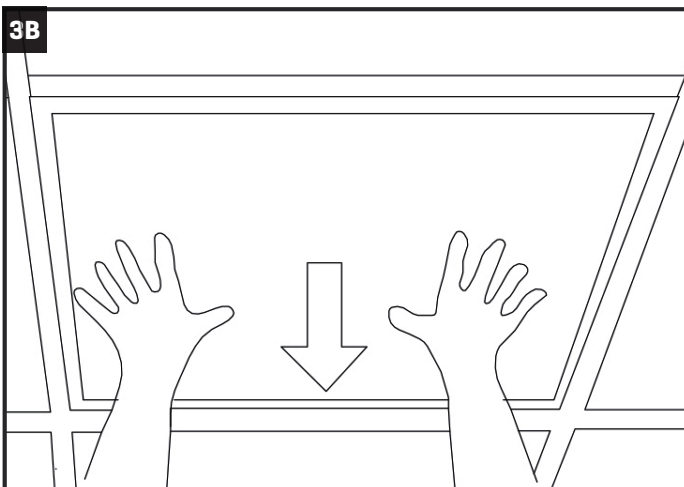
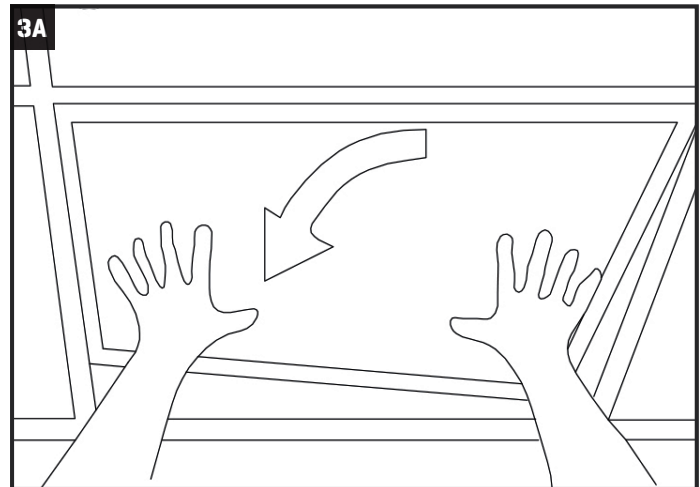
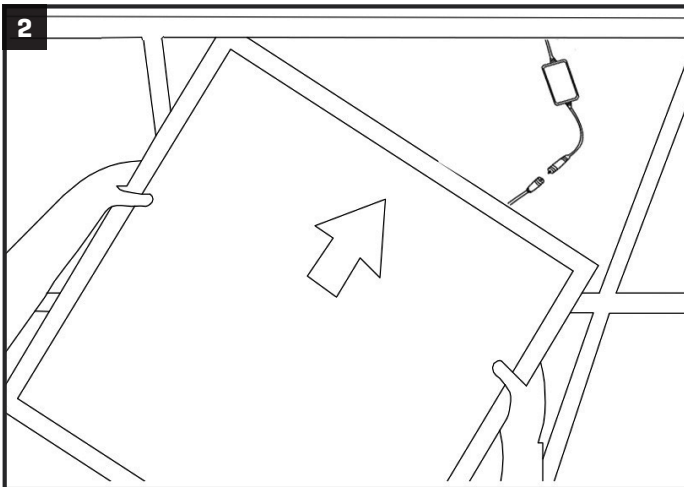
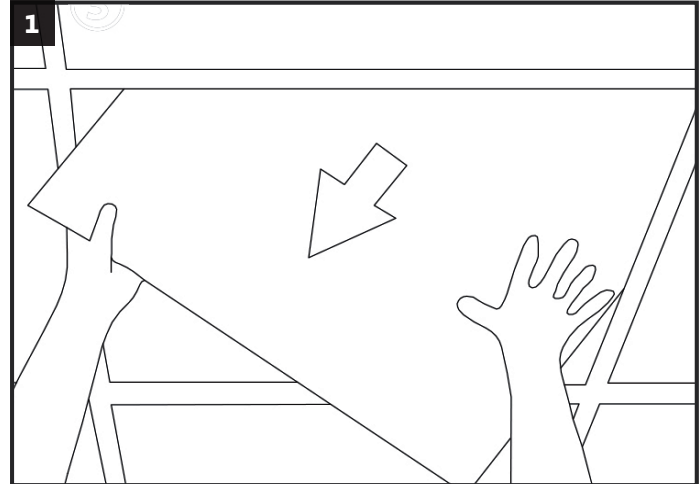

## GUARANTEE

This product is guaranteed for a period of 3 years from the date of purchase. The guarantee is invalid in the case of improper use, tampering, removal of the Q.C. date label, installation in an improper working environment or installation not according to the current edition of the I.E.E. Wiring Regulations [BS7671].

The guarantee is also invalidated if the luminaire has been insulation tested. Should this product fail during the guarantee period it will be replaced free of charge, subject to correct installation and return of the faulty unit. We do not accept responsibility for any installation costs associated with the replacement of this product. Your statutory rights are not affected. We reserve the right to alter specifications without prior notice.